

# TankJet® AA290

## MOTOR DRIVEN TANK CLEANER

Consistent High-Impact Cleaning  
Day-In and Day-Out

### Features and Benefits

- Dependable, durable motor-driven units provide powerful cleaning and remove the most stubborn residues
- Customize to your cleaning operation. Choose:
  - CE-rated air (AG) or explosion-proof (EP) electric motor
  - Two- or four-nozzle hub
  - 3', 4' or 6' (.9, 1.2 or 1.8 m) shaft length
 Plus, change flow rates through nozzle selection or adjustments to inlet pressure
- Motor positioned outside of tank for longer life and fewer failures due to exposure to harmful cleaning solutions
- Long-life construction features corrosion-resistant 316 stainless steel and PTFE fluoropolymer resin seals
- Optimum impact provided by 55430 series solid stream nozzles: with stabilizer vanes that can be removed for maintenance purposes

### Specifications

<b>Max. tank dia.:</b>	80' (24.4 m)
<b>Flow rate range:</b>	22 to 200 gpm (85 to 757 l/min)
<b>Pressure range:</b>	50 to 250 psi (3.5 to 17 bar)
<b>Max. operating temperature:</b>	200°F (93°C)
<b>Min. tank opening size:</b>	7.25" (184 mm) for two-nozzle hub 8.25" (210 mm) for four-nozzle hub
<b>Spray coverage:</b>	360°
<b>Inlet conn.:</b>	2" NPT or BSPT (F)
<b>Flanges:</b>	8" (203 mm) flange for two-nozzle hub 10" (254 mm) for four-nozzle hub
<b>Motor:</b>	Air, explosion-proof electric
<b>Shaft lengths:</b>	3', 4' or 6' (.9, 1.2 or 1.8 m)

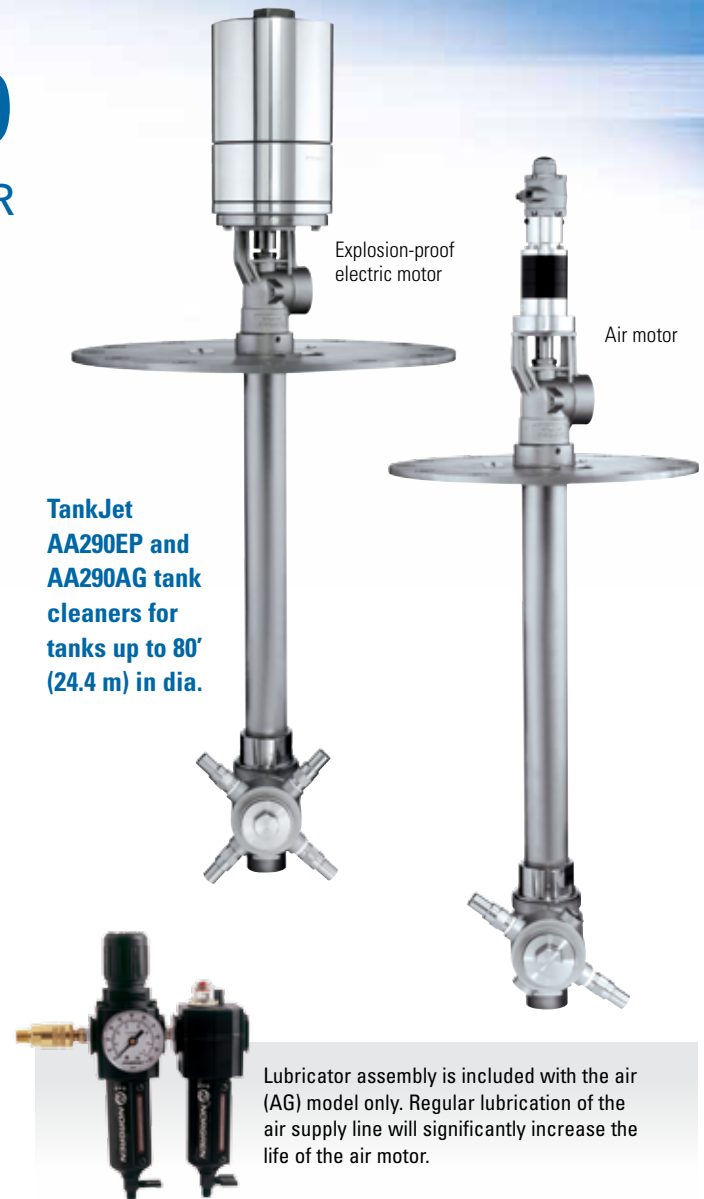

TankJet  
AA290EP and  
AA290AG tank  
cleaners for  
tanks up to 80'  
(24.4 m) in dia.

### Spray Coverage

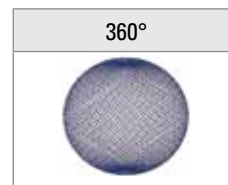

### Ideal for Cleaning:

- Fermentation and yeast tanks and vats
- Flour silos
- Mixing tanks
- Paint tanks

**Performance Data**

<b>Total Flow of Two Nozzles (Equal Capacity) gpm or l/min Liquid Inlet Pressure*</b> Double flow rates when using four nozzles up to 200 gpm (752 l/min)					
Nozzle No.	50 psi (3.5 bar)	100 psi (7 bar)	150 psi (10 bar)	200 psi (15 bar)	250 psi (17 bar)
55430-H3/4U-00100	22 (85)	32 (121)	39 (144)	45 (177)	50 (188)
55430-H3/4U-00200	45 (171)	63 (241)	77 (288)	89 (353)	100 (376)
55430-H3/4U-00250	56 (213)	79 (301)	97 (360)	112 (441)	125 (470)
55430-H3/4U-00350	78 (298)	111 (422)	136 (505)	157 (618)	175 (658)
55430-H3/4U-00400	89 (341)	126 (482)	155 (577)	179 (706)	200 (752)

\*Note: Liquid inlet pressure measured near inlet connection of tank cleaner.

**Cycle Time Data – Air Motor (AG)**

Air Pressure psi (bar)	Air Consumption scfm (l/sec)	Approx. Speed (rpm)		Approx. Time for One Complete Cycle (min.)	
		50 psi (3.4 bar)	250 psi (17.2 bar)	50 psi (3.4 bar)	250 psi (17.2 bar)
12 (0.83)	4.7 (2.2)	6	2	11	32
14 (0.97)	5.4 (2.5)	8	4	7	17
16 (1.10)	6.3 (3.0)	10	8	6	8
18 (1.24)	7.1 (3.4)	–	9	–	7

**Cycle Time Data –  
Explosion-Proof Motor (EP)**

Approx. Speed (rpm)	Supply	Approx. Time for One Complete Cycle (min.)
4	120 VAC 60 Hz	16

**Dimensions and Weights – Air Motor (AG)**

Model No.	Extension Length	Overall Length	Weight with 8" Flange	Weight with 10" Flange
AA290AG_F3	3' (0.9 m)	60-7/8" (1.5 m)	56 lbs (25.5 kg)	63 lbs (28.7 kg)
AA290AG_F4	4' (1.2 m)	72-7/8" (1.8 m)	60 lbs (27.3 kg)	67 lbs (30.5 kg)
AA290AG_F6	6' (1.8 m)	96-7/8" (2.5 m)	69 lbs (31.4 kg)	76 lbs (34.6 kg)

**Dimensions and Weights –  
Explosion-Proof Motor (EP)**

Model No.	Extension Length	Overall Length	Weight with 8" Flange	Weight with 10" Flange
AA290E_F-EP3	3' (0.9 m)	61-3/4" (1.6 m)	66 lbs (30.1 kg)	73 lbs (33.2 kg)
AA290E_F-EP4	4' (1.2 m)	73-3/4" (1.8 m)	70 lbs (31.9 kg)	77 lbs (35.0 kg)
AA290E_F-EP6	6' (1.8 m)	97-3/4" (2.5 m)	79 lbs (36.0 kg)	86 lbs (39.1 kg)

**Spray Head Tank Diameter Opening with Two Nozzles**

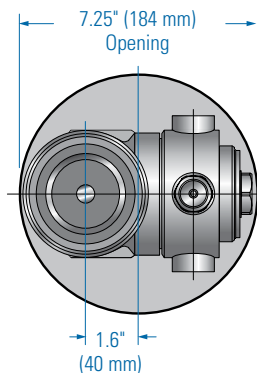

**Spray Head Tank Diameter Opening with Four Nozzles**

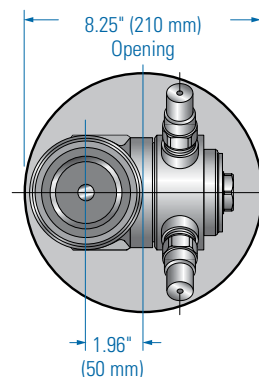

### Flange Specifications

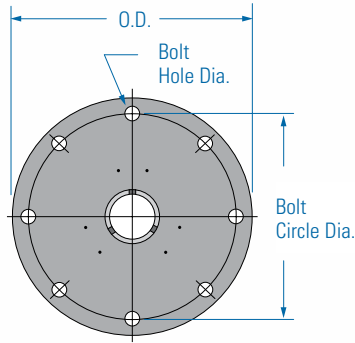

**8" flange**

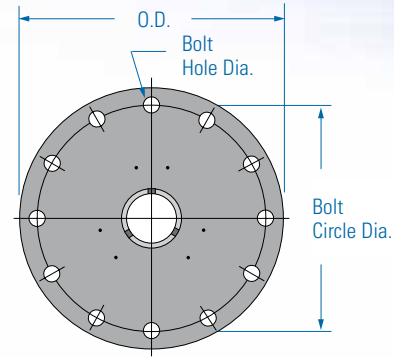

**10" flange**

Flange Size	Flange O.D.	Bolt Circle Diameter	No. of Flange Holes	Bolt Hole Diameter	Thickness
8" flange	13.5"	11.75"	8	0.875"	3/8"
10" flange	16"	14.25"	12	1.00"	3/8"

### Ordering Information

Tank Cleaner					Nozzle No.						
AA290AG	8F	-	3	- 2 +	55430-H	3/4	U	-	316SS	-	00100
Tank Cleaner Type	8" Flange	Extension Length	Hub Type (No. of Nozzles)	Nozzle Type Prefix	Nozzle Inlet Conn.	Nozzle Type	Material Code	Capacity Size			

Add B after AA in the tank cleaner type and prior to nozzle type prefix for BSPT connections.

Tank Cleaner					Nozzle No.						
AA290E	10F	-	EP	- 3 - 4 +	55430-H	3/4	U	-	316SS	-	00100
Tank Cleaner Type	10" Flange	Explosion-proof Motor	Extension Length	Hub Type (No. of Nozzles)	Nozzle Type Prefix	Nozzle Inlet Conn.	Nozzle Type	Material Code	Capacity Size		

Add B after AA in the tank cleaner type and prior to nozzle type prefix for BSPT connections.

